

Accenture Tower

500 West Madison

ONE PLACE. EVERY TASTE.



THE OPPORTUNITY

40 FLOORS
 1.4 MILLION SF OFFICE SPACE
 70,000 SF RETAIL
 RETAIL/TRANSPORTATION CENTER

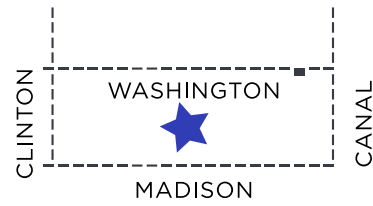

FOOD COURT
 GENERATES
 HIGH
 VOLUME
 TRAFFIC

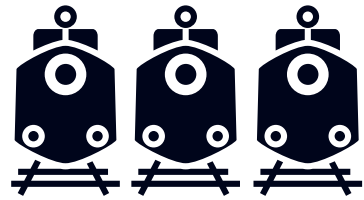

**TERMINAL FOR THREE
 METRA ROUTES**

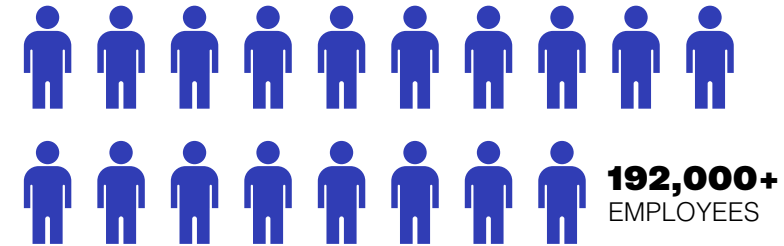
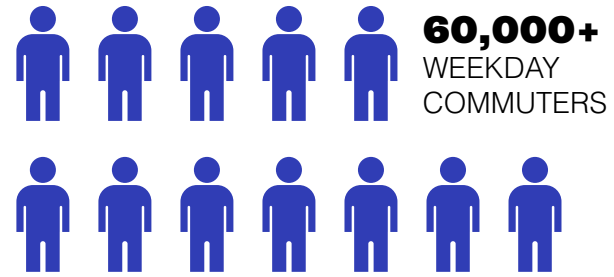

**WITHIN
 4
 BLOCKS**



**40 Million
 SQUARE FEET**



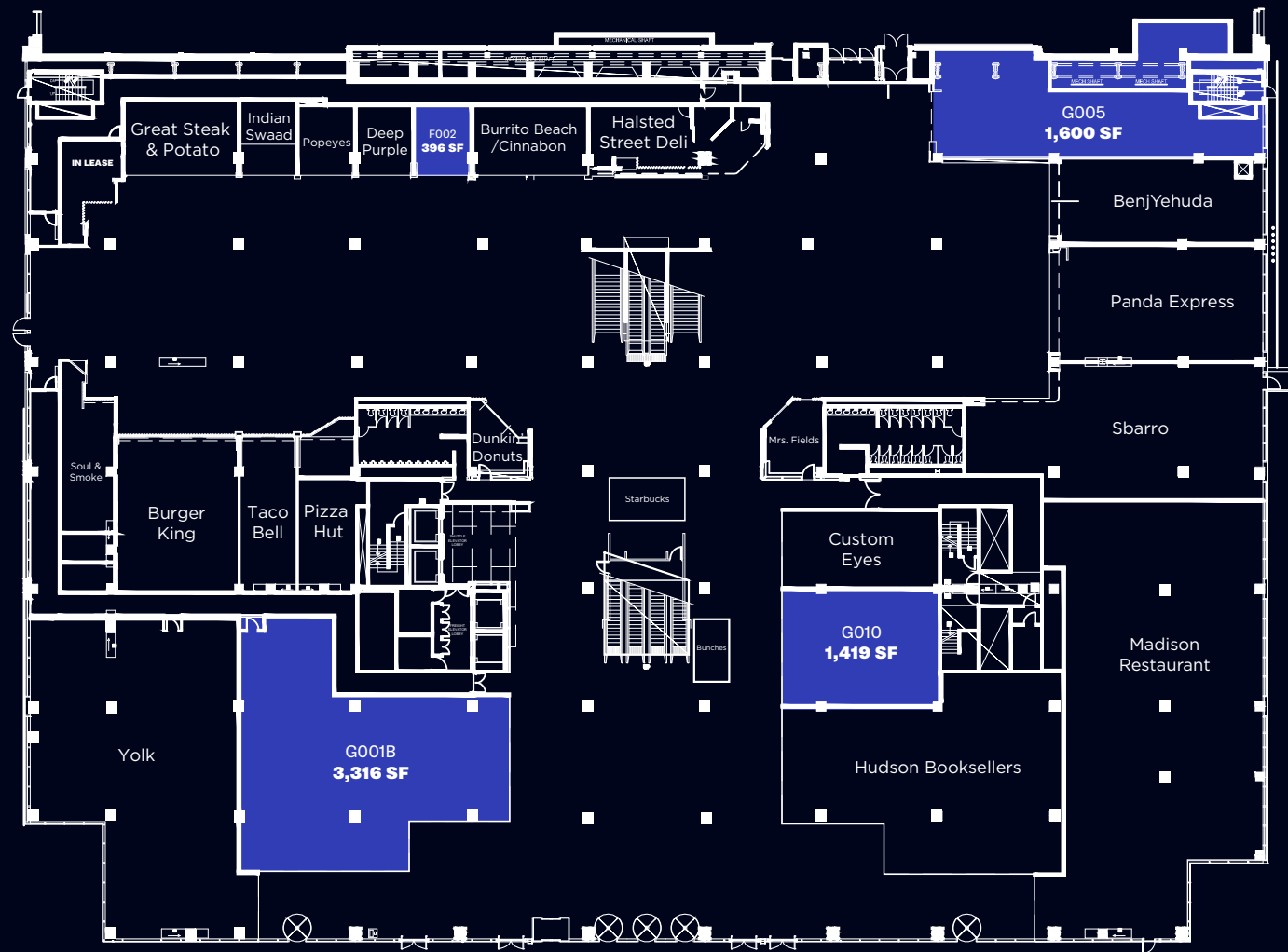

GROUND LEVEL

396 SF - F002

Restaurant Infrastructure, No Black-Iron

1,419 SF - G010

1,600 SF - G005

Restaurant Infrastructure, No Black-Iron

3,316 SF - G001B

Accenture Tower

500 West Madison



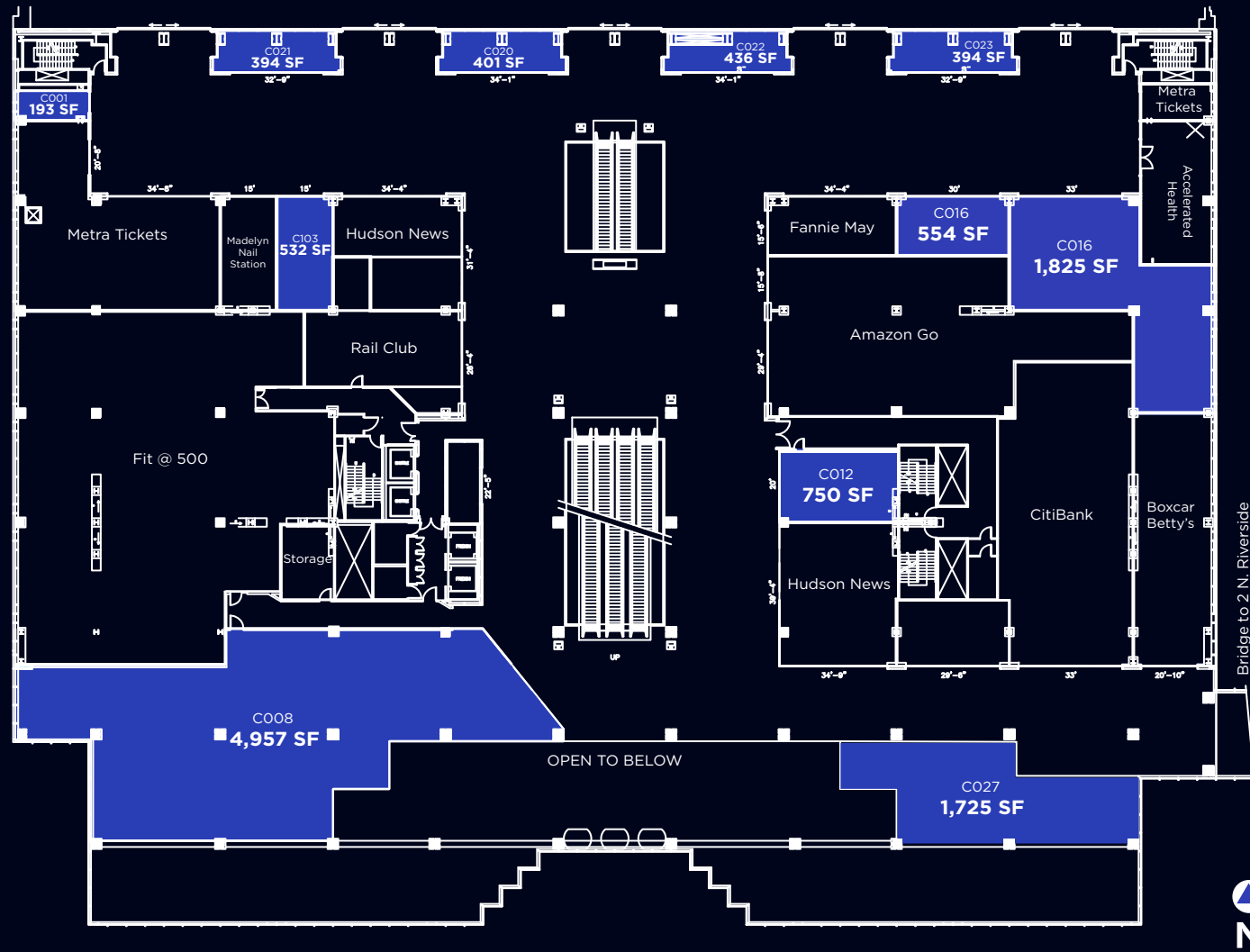

CONCOURSE LEVEL

193 SF - C001

394 SF - C021

394 SF - C023

401 SF - C020

436 SF - C022

532 SF - C103

554 SF - C016

750 SF - C012

Restaurant Infrastructure, No Black-Iron

1,725 SF - C027

Restaurant Infrastructure, No Black-Iron

1,825 SF - C015

4,957 SF - C008

Accenture Tower

500 West Madison





LOCATION

50k
DAILY RAIL
COMMUTERS

3
COMMUTER
RAILS

110k
PEOPLE THROUGH
BUILDING DAILY



FOR RETAIL LEASING INFORMATION,
PLEASE CONTACT:

TODD L. SIEGEL

Senior Vice President
todd.siegel@cbre.com
T. 312.861.7834

PHILLIP GOLDING

First Vice President
phillip.golding@cbre.com
T. 312.338.2045

KIMBERLY WISKUP

Senior Associate
kimberly.wiskup@cbre.com
T. 312.935.1943

CBRE

©2023 CBRE, Inc. All rights reserved. This information has been obtained from sources believed reliable, but has not been verified for accuracy or completeness. You should conduct a careful, independent investigation of the property and verify all information. Any reliance on this information is solely at your own risk. CBRE and the CBRE logo are service marks of CBRE, Inc. All other marks displayed on this document are the property of their respective owners, and the use of such logos does not imply any affiliation with or endorsement of CBRE. Photos herein are the property of their respective owners. Use of these images without the express written consent of the owner is prohibited. PMStudio_March 2023